

**XT-5315/5515/5515Pro**  
**P-CAP Touch Terminal**  
**User Manual**



**Package Contents**

- ✓ 15" P-CAP touch terminal with Gen 7E or Gen 8E base.....(x 1)
- ✓ Power adapter.....(x 1)
- ✓ Power cord.....(x 1)

**SOME IMPORTANT NOTES**

**FCC NOTES**

This system meets industry & government requirements and applicable standards. This equipment generates, uses, and can radiate radio frequency energy and, if not installed and used in accordance with the instructions manual, may cause interference to radio communications. It has been tested and found to comply with limits for a Class A digital device pursuant to subpart B of Part 15 of FCC Rules, which are designed to provide reasonable protection against interference when operated in a commercial environment. Operation of this equipment in a residential area is likely to cause interference in which case the user at his own expense will be required to take whatever measures to correct the interference.

This device complies with part 15 of the FCC Rules. Operation is subject to the following two conditions: (1) This device may not cause harmful interference, and (2) this device must accept any interference received, including interference that may cause undesired operation.

**CE CLASS A WARNING**

This equipment is compliant with Class A of CISPR 32. In a residential environment this equipment may cause radio interference.

**AVERTISSEMENT CE CLASSE A**

Cet équipement est conforme à la classe A de CISPR 32. Dans un environnement résidentiel, cet équipement peut provoquer des interférences radio.

**WARRANTY LIMITS**

Warranty will terminate automatically when the machine is opened by any person other than the authorized technicians. The user should consult his/her dealer for the problem happening.

Warranty voids if the user does not follow the instructions in application of this merchandise. The manufacturer is by no means responsible for any damage or hazard caused by improper application.

**LIMITES DE GARANTIE**

La garantie prend fin automatiquement lorsque la machine est ouverte par une personne autre que les techniciens autorisés. L'utilisateur doit consulter son revendeur pour le problème qui se produit. La garantie s'annule si l'utilisateur ne suit pas les instructions d'application de cette marchandise. Le fabricant n'est en aucun cas responsable de tout dommage ou danger causé par une mauvaise application.

## 警告使用者

為避免電磁干擾，本產品不應安裝或使用於住宅環境。

## SAFETY INSTRUCTIONS

This equipment is not suitable for use in locations where children are likely to be present.

## CONSIGNES DE SÉCURITÉ

Cet équipement ne convient pas à une utilisation dans des lieux pouvant accueillir des enfants.

## WARNING

Power cord shall be connected to a socket-outlet with earthing connection.

## ATTENTION

Le cordon d'alimentation doit être connecté à une prise de courant avec mise à la terre.

## BATTERY WARNING

Risk of explosion if battery is replaced by an incorrect type. Dispose of expended battery in accordance with local disposal regulations.

## AVERTISSEMENT DE BATTERIE

Risque d'explosion si la batterie est remplacée par un type incorrect. Jetez la batterie usagée conformément aux réglementations locales en matière d'élimination.

## 警告

本電池如果更換不正確會有爆炸的危險，請依製造商說明書處理用過之電池。

## Views of XT-5315/5515/5515Pro with Gen 7E Base

### Front View



### Rear View



### Side View

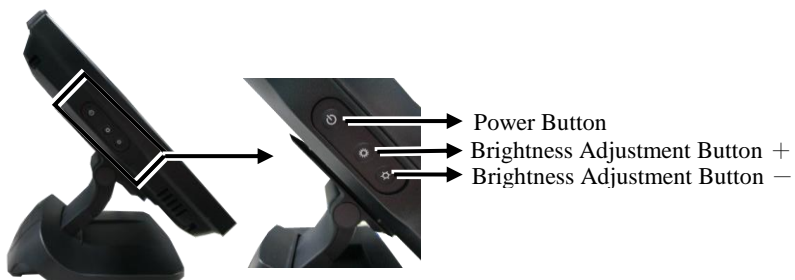

### Bottom View

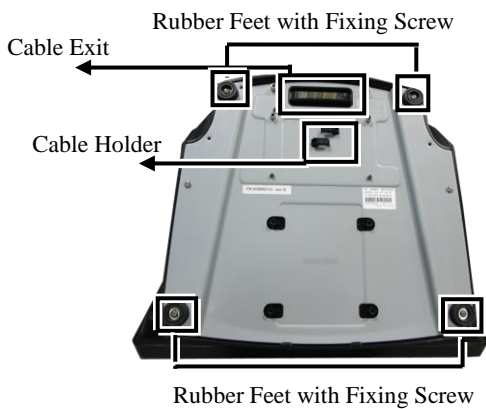

## Views of XT-5315/5515/5515Pro with Gen 8E Base

### Front View



### Rear View



### Side View

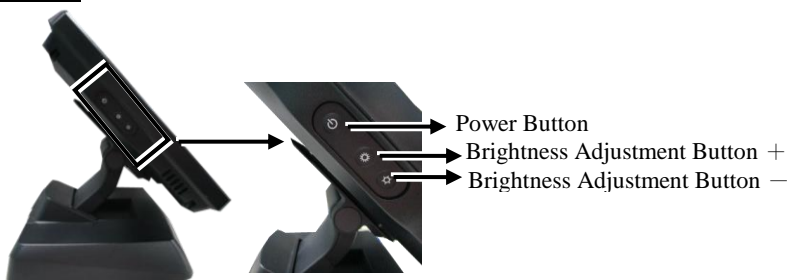

## Bottom View

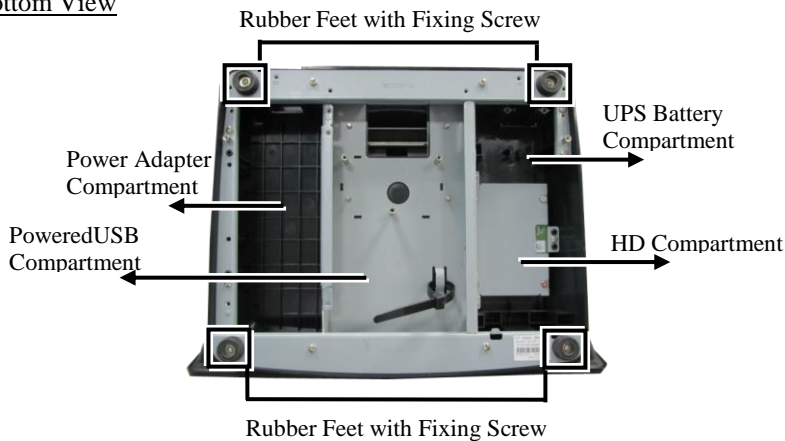

## **View of I/O Interface of XT-5315/5515**

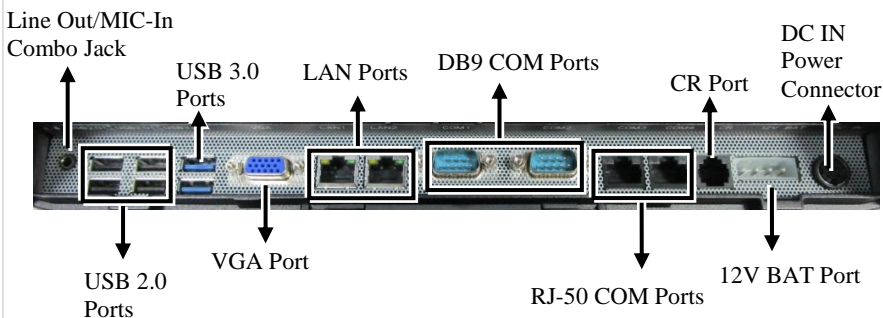

## **View of I/O Interface of XT-5515Pro**

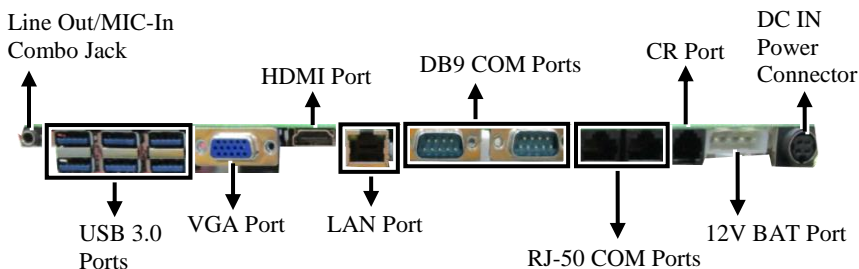

## Positioning your POS for a Perfect Viewing Angle

The adjustable bases designed for XT-5315/5515/5515Pro come in two models, Gen 7E/8E, and allow you to determine an ideal position for your terminal by using its unique tilt adjustment mechanism. As the below figures suggest, both bases provide three standard positioning solutions for your terminal: **Flat Folded mode**, **Low Profile mode**, and **Full Extended mode**.

### XT-5315/5515/5515Pro with Gen 7E Base



**Flat Folded mode**



**Low Profile mode**



**Full Extended mode**

### XT-5315/5515/5515Pro with Gen 8E Base



**Flat Folded mode**



**Low Profile mode**



**Full Extended mode**

In general, XT-5315/5515/5515Pro will be set up beforehand in **Flat Folded** mode and then packaged into the box for shipping. After it is unpacked, you may re-adjust the terminal in either **Low Profile** mode or **Full Extended** mode according to your situation. Below will provide instructions on how to adjust the specific base connected to the POS system. As a reminder, please be careful not to touch the LCD panel while setting up the tilt angle.

### XT-5315/5515/5515Pro with Gen 7E Base

Please refer to the following instructions on how to switch among different positioning modes to find an ideal viewing angle for XT-5315/5515/5515Pro with Gen 7E base.

1. Unpack XT-5315/5515/5515Pro, which is supposed to be set in flat folded mode, out of the package box and then lay your POS system on a flat surface.
2. Steady the base with one hand, and then tilt the screen downwards.



### 3. Position your terminal in **Full Extended mode**

- 3.1 After grabbing the bottom edge of the screen with your hand, gently move the screen upward until the screen is locked into place with a click sound.

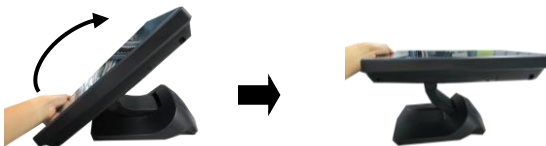

- 3.2 Support the screen with one hand holding onto its bottom edge. Then, while pulling the lever backwards, move the display upwards until the lever is snapped into the lower hook to raise the screen as shown in the below figure.

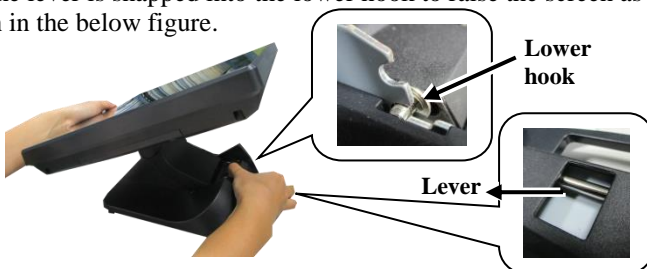

- 3.3 With the screen facing toward you, tilt the screen up or down to your desired angle. Please do not press on the LCD panel while setting up the tilt angle.
- 3.4 Remove the cable cover from the base.



- 3.5 Fix the base with two #/6/32-14L screws.

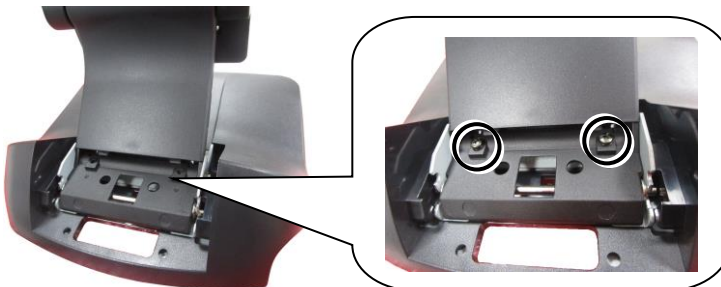

4. Return your terminal back to **Flat Folded mode** from **Full Extended mode**.

- 4.1 Remove the cable cover from the base.



- 4.2 Remove the two screws from the base.

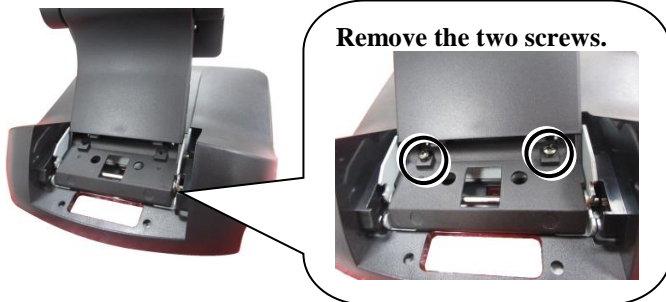

- 4.3 Tilt your screen in a horizontal position.



- 4.4 Support the screen with one hand holding onto its bottom edge. While pulling the lever backwards, move the display downwards until the lever is lifted off the hook as shown in the figure.





4.5 Push the cable cover back.



4.6 Tilt the screen again to the horizontal position.



5. Position the terminal in **Low Profile mode**.

5.1 Follow Step 4 to set up the terminal in Flat Folded mode.



5.2 Tilt the screen all the way down



5.3 To tilt screen up or down to your desired angle, please be advised to keep the base steady with one hand to do so. Do NOT press on the LCD panel while setting up the tilt angle.



#### XT-5315/5515/5515Pro with Gen 8E Base

Please refer to the following instructions on how to switch among different positioning modes to find an ideal viewing angle for XT-5315/5515/5515Pro with Gen 8E base.

1. Unpack XT-5315/5515/5515Pro, which is supposed to be set in flat folded mode, out of the package box and then lay your POS system on a flat surface.
2. While steadying the terminal with your hand holding onto the base, tilt the screen down.



3. Push the cable cover outwards to remove it from the base.



4. Position your terminal in **Full Extended mode**.

- 4.1 Support the screen with one hand holding onto its bottom edge. Then, while pulling the lever backwards, move the display upwards until the lever is snapped into the lower hook to raise the screen as shown in the below figure.

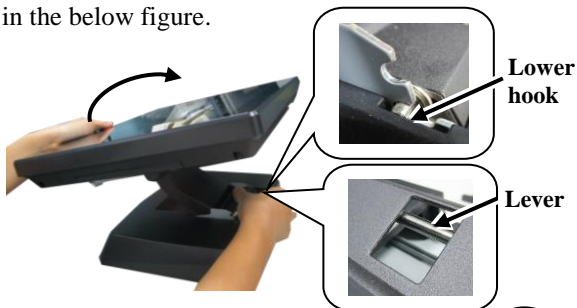

- 4.2 Tilt the screen up or down to your desired angle. Please do not press on the LCD panel while setting up the tilt angle.



- 4.3 Fix the base with two #/6/32-14L screws.

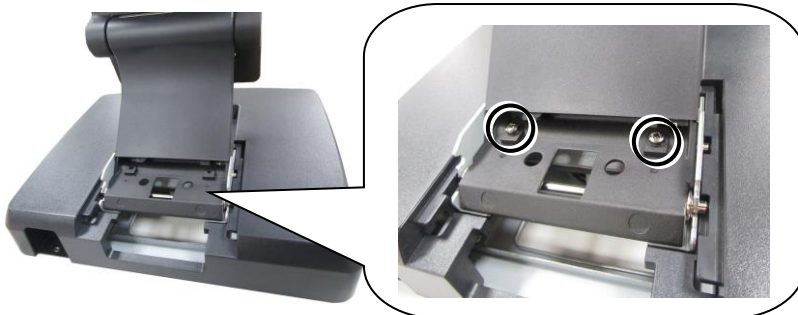

4.4 Push the cable cover back.



5. Position the terminal in **Low Profile mode**.

5.1 While keeping your terminal steady with your hand holding on to the base, tilt your terminal down. Then, remove the cable cover from the base.

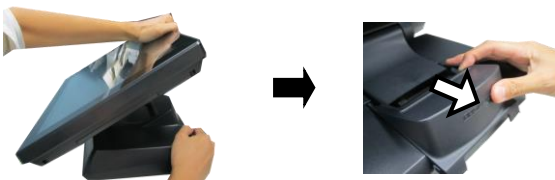

5.2 Remove the two screws from the base.

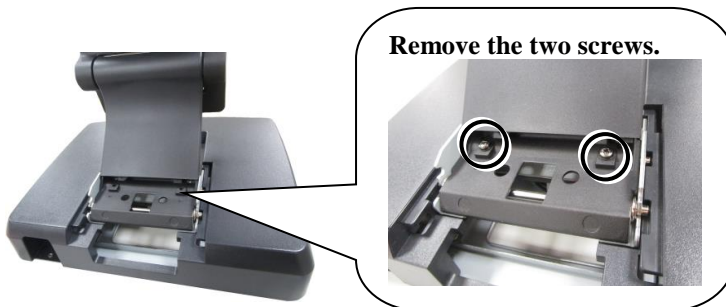

5.3 Support the screen with one hand holding onto its bottom edge. Then, while pulling the lever backwards, move the display upwards or downwards until the lever is snapped into the upper hook to lower the screen as shown in the below figure.



5.4 Push the cable cover back.

5.5 Tilt the screen up or down to your desired angle. Please do not press on the LCD panel while setting up the tilt angle.

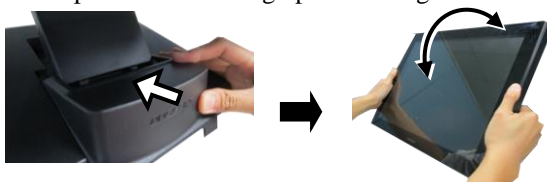

6. Return the terminal back to **Flat Folded mode**.

6.1 While steadying your terminal with your hand holding onto the base, tilt your screen up. Remove the cable cover from the base.

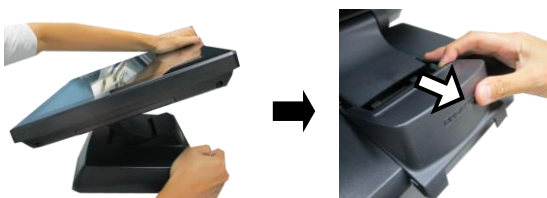

6.2 Support the screen with one hand holding onto its bottom edge. While pulling the lever backwards, release the lever back to the point above the upper hook as shown in the figure.



6.3 Push the cable cover back.

6.4 Tilt the screen to the horizontal position.

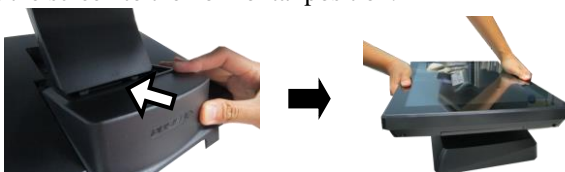

## Connecting Power Adapter and I/O Cables

To have the terminal ready for operation, please connect the connector of power adapter and all of the connectors of required I/O cables respectively to the 12VDC-IN power jack and appropriate I/O ports. Please make sure that each of the cables is fully connected to each of the correct ports. Damages due to incorrect connection or orientation are not covered by product warranty!

Some cable connectors like the connectors of the COM or LAN cables have to be gently inserted until a click is heard. It is recommended that the I/O ports, such as COM port, should be screwed after the I/O cable connectors are completely connected. And please make sure that each connector has to be connected to the right peripheral device in the right way.

**CAUTION:** On doing insertion or extraction of a cable connector, please always hold the connector head itself instead of pulling the cable wire. Doing this could damage the cables and ports, which is considered as an artificial damage and is not covered by the warranty. The means of power cord should be connected to a socket-outlet with earthing connection.

**ATTENTION:** Lors de l'insertion ou de l'extraction d'un connecteur de câble, veuillez toujours tenir la tête du connecteur elle-même au lieu de tirer le fil du câble. Cela pourrait endommager les câbles, ce qui est considéré comme un dommage artificiel et n'est pas couvert par la garantie. Le cordon d'alimentation doit être connecté à une prise de courant avec mise à la terre.

## Routing and Arranging Cables

Gen 7E/8E bases feature their own cable management to help you well organize the cords whenever you need to connect peripheral devices to XT-5315/5515/5515Pro. The following provides some useful cable-routing instructions required to manage your cables.

1. Set up your terminal in Full Extended mode and then tilt the screen all the way down.



2. Remove the cable cover.



3. Pull outwards the locking levers with your forefingers and then remove the neck cover in the direction shown by the arrow.



4. Tilt the screen to the horizontal position. Thread the cables along the cable passage and then through the cable exit.



5. Tilt the terminal up enough to have the bottom I/O plate towards you. Locate the cable arrangement cover as shown in the figure.



**Cable Arrangement Cover**

6. Remove the cable arrangement cover by pushing it up in the direction shown by the arrow.



7. Properly insert the cable into the correct port on the bottom I/O plate.



8. Neatly arrange your cable. Then, make sure the cord can be held into place and passed through the cable exit after sliding back the cable arrangement cover.



**Cable Exit**

9. Have the screen tilt all the way down, and then push the neck cover back into place.
10. Place the cable cover back.

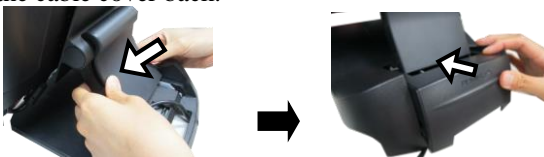

11. Make sure the cable is threaded through the cable exit at the bottom of the base.



Gen 7E base



Gen 8E base

## **Installing Optional Upgrade Kits and Peripherals**

XT-5315/5515/5515Pro is an expandable model which allows you to upgrade its own capacity by additionally installing multiple peripheral devices, such as magnetic stripe reader (MSR), LCD monitor and cash drawer, according to your preference. The following will give you installation instructions on how to expand on your current POS system with these optional upgrade kits. Before proceeding with the installation of peripherals, please make sure the POS system is completely shut down to prevent damage.

### ➤ **Installing UPS Battery to Gen 8E Base**

UPS battery compartment can be found at the bottom of Gen 8E base as shown in the figure. Please be advised that the installation of UPS battery should be conducted by a technician according to the user manual specific to UPS battery.



### ➤ **Installing PoweredUSB to Gen 8E Base**

The middle compartment at the bottom of Gen 8E base is designed to install PoweredUSB. However, the installation of PoweredUSB is required to be conducted properly and accurately, so please contact your service provider for help. The detailed installation guide will be provided in the relevant technical manual.



### ➤ **Installing Power Adapter to Gen 8E Base**

Power adapter is used to provide power which your terminal needs to be operated normally. Please go through the below steps to install the power adapter into Gen 8E base. If the power adapter is already installed to Gen 8E base, you may skip this section.

1. Lay your POS terminal on a flat surface with its bottom facing towards you.



2. Take the AC power adapter with its rubber feet facing you. Place the bottom side of the power adapter into the bottom of the power adapter compartment first, and then push the top side of the adaptor into the compartment.



3. After pushing the power adapter up to the top, place two brackets separately on the top and bottom sides of the power adapter compartment as shown in the figure. Then, fasten two brackets with four fixing screws.



4. Before threading the cable through the cable exit, loosen two fixing screws for the bracket of the PoweredUSB compartment. Then, slide the bracket in the direction shown by the arrow to remove the bracket.





5. Pass the cable of the power adapter through the cable exit and then connect it to the port on the I/O plate of your POS system. (Please refer to **Routing and Arranging Cables** section to thread the cable, according to the model of your base.)

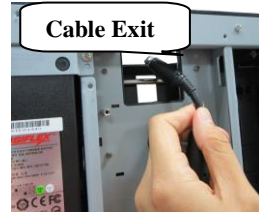

6. Neatly thread the cord along the bottom edge of the PoweredUSB compartment (1), and then use the cable tie to hold the extra cable (2) as shown in the figure.

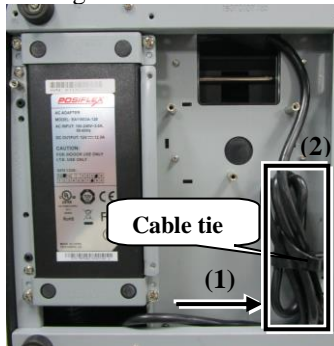

7. Place back the PoweredUSB compartment bracket into place, and then secure it using two fixing screws.



8. Lay the POS terminal on a flat surface with its rear facing towards you. Then, connect the female end of power cord to the power adapter and the other end to the electrical outlet.



9. To hold the power cord into place, attach the screw hole of power cord holder to the hole at the bottom of Gen 8E base, and then use a fixing screw to secure the power cord holder.

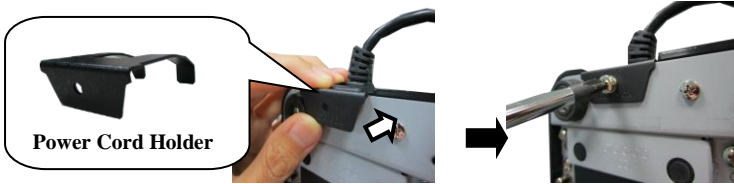

➤ **Installing Side Mount Upgrade Kits**

Located at left side on the back of your LCD panel, side mount compartment is mainly used for installation of side-mounted equipment, such as magnetic stripe reader. For detailed installation instructions, please refer to the user manual specific to the device which you intend to mount onto the terminal.



➤ **Installing Rear Top Mount Upgrade Kits**

Rear top mount upgrade kits, including customer pole displays and monitors, have to be mounted onto the top side on the rear of your POS terminal as shown in the figure. As for the installation instructions along with the individual cable arrangement for the specific base, please be advised to read the user manual specific to the device you intend to install.



➤ **Installing Wall Mount Kits**

The wall mount kits enable you to mount your POS terminal onto the wall as an alternative. For detailed installation instructions, please be advised to refer to the user manual specific to wall mount kits.

## **Installing an Operating System**

You are highly advised not to install an operating system on XT-5315/5515/5515Pro without professional instructions. Not only might the careless handling during installation cause irreversible damage to your machine, but also the improper installation likely leads to system malfunction or failure. Please contact with your dealers about the issues of operating system installation.

## Performing System Recovery

For XT-5315/5515/5515Pro models with preloaded operating systems, you are not encouraged to recover your system without the help of system integrators. Please be advised to contact your service center for further assistance with system recovery.

## Operation Environment

To prevent XT-5315/5515/5515Pro from overheating, it is suggested to position your terminal in a well-ventilated working environment. In doing so, please be advised to keep the POS terminal at least 25mm away from other devices to ensure the machine is properly cooled down and functioning normally.

## Powering ON/OFF XT-5315/5515/5515Pro

### Power ON XT-5315/5515/5515Pro

Press down the power button for at least 3 seconds to power on the POS.

### Power OFF XT-5315/5515/5515Pro

In most cases, press the power button of the POS to power the system off. If the terminal fails to turn off the machine for unknown reasons, please be advised to hold the power button more than 10 seconds to force a shutdown of the system.

## Status LED Indicator

LED status indicator, which is located at the bottom edge of the LCD panel, is mainly responsible for notifying users of the current system status by emitting various LED signals. In the chart provided below, it describes all the possible LED status as a quick reference.

LED Status	System status	AC power supply	UPS Battery	Description
Off	OFF	OFF	Without battery	System power OFF
Off	OFF	OFF	With battery	System power OFF
Green	OFF	ON	With/Without battery	System standby
Blue	ON	ON	With/Without battery	System power ON
Blinking blue	ON	OFF	With battery	System running on UPS battery
Blinking green	ON	OFF	With battery	UPS battery low

## Specifications

	XT-5315	XT-5515	XT-5515Pro
CPU	Intel Haswell CPU, LGA 1150 Package		
DRAM Memory	SO-DIMM socket x2, DDR-3 1600, Max. 16GB		
Storage Device	SATAIII x2 (2.5" HDD)		
RAID Function	N/A	RAID0, RAID1	
Intel vPro support	N/A	Yes	
TPM Function	N/A	Yes	
Power Supply	12V/130W (upgrades to 12V/150W for PoweredUSB)		
OS Support	POSReady 7 / Win 7 / Linux / Win8 / Win 10 IoT		
LCD Display	15" TFT LCD, 1024 x 768		
Touch Function	5 wires, bezel-free P-CAP touch panel		
Serial Port	Max. 6 ports, DB9 x2, RJ45 x2 (RJ-45 to DB9 Cable Optional), Box-Header x1 (Y cable to DB9 x2 Optional)		
Parallel Port	1 port, Box-header x1 on back window (Optional)		
HDMI Port	N/A		1 port
Display Port	1 port, Box-header x1		N/A
Standard USB Port	8 ports, 6ports on the Rear I/O (USB3.0 x 2 & USB2.0 x 4), 2 internal proprietary ports for extension device		8 ports, 6ports on the Rear I/O (USB3.0 x 6), 2 internal proprietary ports for extension device
PoweredUSB	(Optional) PU-480 : 24V x 1 + 5V x 8 via Gen 8E base PU-490 : 24V x 1 + 12V x 3 via Gen 8E base		
LAN Port	2 ports, 10 / 100 / 1000 Mb x 2		1 port, 10/100/1000 Mb x1 (Intel i217LM only)
VGA Port	1 port, D-SUB 15 Pin with 12V power for Posiflex LCD Monitor		
CR Port	1 port, controlling 2 CR		
PS/2 Keyboard	1 port, Box-header x1 on back window		
UPS Port	Yes, optional 2300mAh/12V Battery		
Audio Port	Mic-in / Line-Out for Combo Jack		
Extension Slot	mini-PCIe slot x 1, USB interface support		
Power Indicator LED	Power On/Standby, bi-color LED indicators Ethernet link LED on Ethernet connector		
Wireless LAN	Optional, through mini-PCIe slot		
Dimension	372 x 320 x 252.7 (W x D x H in mm)		
Weight	5.86 (N. W. in kg)		
Environmental Requirements	Operating : 0°C ~ 40°C, 20%RH - 90%RH Storage : -20°C ~ 60°C, 10%RH - 90%RH		

***※ The product information and specifications are subject to change without prior notice.***